

Applying for English-language education for the 1st Grade

School year 2026–2027



About arranging basic education

- Espoo, like other municipalities, has an obligation to arrange basic education for children of compulsory school age residing in its area. Pupils have a **subjective right to attend a local school** (primary school) assigned by the municipality. Basic education is given in Finnish.
- Pupils who cannot yet speak Finnish or whose Finnish language skills are not equivalent to those of a native speaker have the **opportunity to be supported in increasing their Finnish language skills and to participate in preparatory education.**
- Pupils can apply for English-language education. Pupils, however, **do not have a subjective right to be admitted to English-language education**, as opposed to applying to a local school.

English-language education in Espoo

- Intended for pupils **who live in Espoo**.
- One form of **weighted-curriculum education** in Espoo.
- **Nearly all the teaching is in English.** The aim is to give the pupils the kind of linguistic skills that enable them to continue their studies in both English and Finnish even after basic education.
- **Follows the national Finnish curriculum in all subjects.**
 - The A1 language is English and the A2 language either French or Spanish.
 - Finnish is studied either as mother's tongue or according to the Finnish as a Second Language curriculum (S2).





English-language education in Espoo

Schools

- **Grades 1-9:** Espoo International School
- **Grades 1-6:** Kivimies International School

Study places

- Espoo International School, 50 (middle school 100)
- Kivimies International School, 25

Admission criteria

- In accordance with the admission criteria for English-language education decided by the Growth and Learning Committee.

English-language education in Espoo

Allocation of lesson hours (grades 1–6)

Espoo 1 extra hour allocated to Finnish in grades 1 and 2, in grade 3 to science.

Arts and crafts hours in grades 3 to 6:

- 3rd Grade 1 hrs crafts
- 4th Grade 1 hrs music
- 5th and 6th Grades 2 hrs crafts

| | 1st Grade | 2nd Grade | 3rd Grade | 4th Grade | 5th Grade | 6th Grade |
|--------|-----------|-----------|-----------|-----------|-----------|-----------|
| ENG | 4 hrs | 5 hrs | 4 hrs | 3 hrs | 3 hrs | 3 hrs |
| FIN(2) | 5 hrs | 4 hrs | 5 hrs | 4 hrs | 3 hrs | 3 hrs |

The differences between English and Bilingual education (Finnish-English)

| English-language Education | Bilingual Education (Finnish-English) |
|---|--|
| Finnish National Core Curriculum for Basic Education | |
| Allocation of lesson hours, slight differences FIN vs. ENG | |
| Max 25 pupils per class | |
| English as medium of instruction for all subjects | More subjects taught in Finnish in higher grades |
| One form of weighted-curriculum education in Espoo | One form of weighted-curriculum education in Espoo |
| International School: Espoo International School (Grades 1-9) Stream within a Finnish primary School: Kivimies International School (Grades 1-6) | Stream within a Finnish primary School: <ul style="list-style-type: none"> ▪ Jalavapusto (Grades 1-6) ▪ Kilonpuisto (Grades 1-9) ▪ Kuitinmäki (Grades 1-9) ▪ Niittykumpu (Grades 1-6) ▪ Haukilahti (Grades 7-9) ▪ Nöykkiö (Grades 7-9) |
| A1 language: EN A2 languages: FR, ES | A1 language: EN A2 languages: GER (Niittykumpu GER + SWE, Kuitinmäki GER + FR) |

How to apply

Enrolling in the 1st grade and applying for English-language education

- Enrolling in the 1st Grade and applying for English-language education takes place through the electronic Wilma service **between 8th and 20th January, 2026** by filling in the form 'Application for 1st Grade of Comprehensive School'.
- Online registration **requires a personal Wilma user account**. In order for you to create a personal Wilma account, you must have a valid email address.
- Create** your own personal Wilma account at <https://espoo.inschool.fi/connect> by using the **key code** delivered with the letter 'Notification of beginning of compulsory education'.

ESPOON KAUPUNKI
Suomenkielisen perusopetuksen tulosyksikkö
PL 31
02070 ESPOON KAUPUNKI

Ilmoitus oppivelvollisuuden alkamisesta
Notification of beginning of compulsory education

Lapsellasi alkaa oppivelvollisuus torstaina 13.8.2026.
Sinun tulee ilmoittaa lapsesi peruskoulun ensimmäiselle luokalle 8.1.–20.1.2026 verkkopalvelu Wilmassa <https://espoo.inschool.fi> täyttämällä Peruskoulun ensimmäiselle luokalle ilmoittautuminen -lomake. Ilmoittautumislomakkeen täyttämiseksi tarvitset henkilökohtaisen Wilma-tunnuksen.
Wilma-tunnus luodaan osoitteessa <https://espoo.inschool.fi/connect> käyttämällä tämän kirjeen lopussa ilmoitettua avainkoodia. Kummallekin huoltajalle on oma avainkoodi. Tunnuksen luominen edellyttää toimivaa sähköpostiosoitetta. Vanhemman sisaruksen Wilma-tunnusta ei voi sellaisenaan käyttää, mutta avainkoodien avulla voit liittää koulutulokkaan aiempaan tunnukseen.
Säilytä henkilökohtainen Wilma-tunnuksesi. Tunnus on käytössä koko perusopetuksen ajan.
Jos sinulla ei ole mahdollisuutta täyttää lomaketta Wilmassa, voit tulostaa Peruskoulun ensimmäiselle luokalle ilmoittautuminen -lomakkeen osoitteesta www.espoo.fi/opetuksenlomakkeet. Täytetty lomake on postitettava siten, että se on perillä suomenkielisen perusopetuksen tulosyksikössä viimeistään 20.1.2026.
Tutustu Koulun hakeminen -sivustoon espoo.fi/kouluunhakeminen ennen ensimmäiselle luokalle ilmoittautumista.
Jos tästä kirjeestä tai Espoon kaupungin internetsivuilta ei löydy vastausta ilmoittautumiseen liittyvään kysymykseesi, voit olla yhteydessä Espoo-infon puhelinpalveluun p. 09 816 21 tai info@espoo.fi.
Tietolähde: Digi- ja väestötietovirasto

Your child is due to begin his/her compulsory education on Thursday, August 13, 2026.
Enrolling in comprehensive school is carried out online through the electronic Wilma tool, <https://espoo.inschool.fi>. We ask you to fill in the form "Application for 1st grade of Comprehensive School" under the "Forms" section between January 8th and 20th, 2026. Online registration requires a personal Wilma user account.
We ask you to create your own personal Wilma account at <https://espoo.inschool.fi/connect> by using the key codes delivered with this announcement below. In order for you to create a personal Wilma account, you must have a valid email address. You may not use the Wilma account created for an older sibling but are permitted to add the younger sibling using the key codes below.
Please retain your personal Wilma account. The personal Wilma account will be used throughout basic education.
We ask you to familiarize yourself with the Espoo City website espoo.fi/en/schooladmissions for additional information on enrolling in the local school or applying for other form of teaching.
If you have any questions related to logging in and enrolling in school, please contact tel. +358 9 816 21 or info@espoo.fi.
Source of contact information: The Digital and Population Data Services Agency

Avainkoodi / Key code:
Avainkoodi / Key code:

Before applying for English-language education

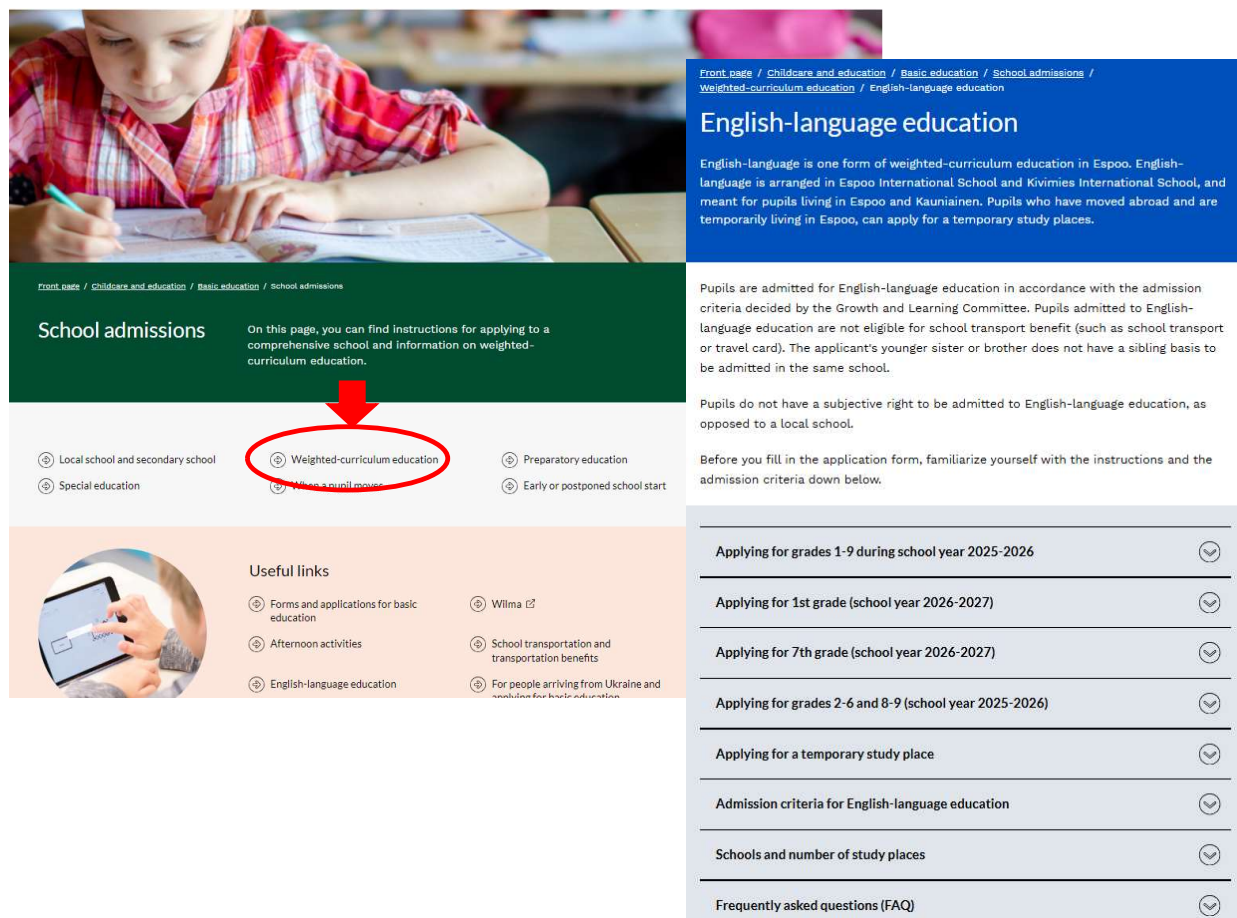

English-language education

English-language is one form of weighted-curriculum education in Espoo. English-language is arranged in Espoo International School and Kivimies International School, and meant for pupils living in Espoo and Kauniainen. Pupils who have moved abroad and are temporarily living in Espoo, can apply for a temporary study places.

Pupils are admitted for English-language education in accordance with the admission criteria decided by the Growth and Learning Committee. Pupils admitted to English-language education are not eligible for school transport benefit (such as school transport or travel card). The applicant's younger sister or brother does not have a sibling basis to be admitted in the same school.

Pupils do not have a subjective right to be admitted to English-language education, as opposed to a local school.

Before you fill in the application form, familiarize yourself with the instructions and the admission criteria down below.

School admissions

On this page, you can find instructions for applying to a comprehensive school and information on weighted-curriculum education.

- Local school and secondary school
- Weighted-curriculum education**
- Preparatory education
- Special education
- For people arriving from Ukraine and seeking for basic education
- Early or postponed school start

Useful links

- Forms and applications for basic education
- Wilma
- Afternoon activities
- School transportation and transportation benefits
- English-language education
- For people arriving from Ukraine and seeking for basic education

Applying for grades 1-9 during school year 2025-2026

Applying for 1st grade (school year 2026-2027)

Applying for 7th grade (school year 2026-2027)

Applying for grades 2-6 and 8-9 (school year 2025-2026)

Applying for a temporary study place

Admission criteria for English-language education

Schools and number of study places

Frequently asked questions (FAQ)

Familiarize yourself with the instructions and the admission criteria at espoo.fi/en/schooladmissions

- > Weighted-curriculum education
- > English-language education

Filling in the form in Wilma

Log in to your personal Wilma account at <https://espoo.inschool.fi/>.

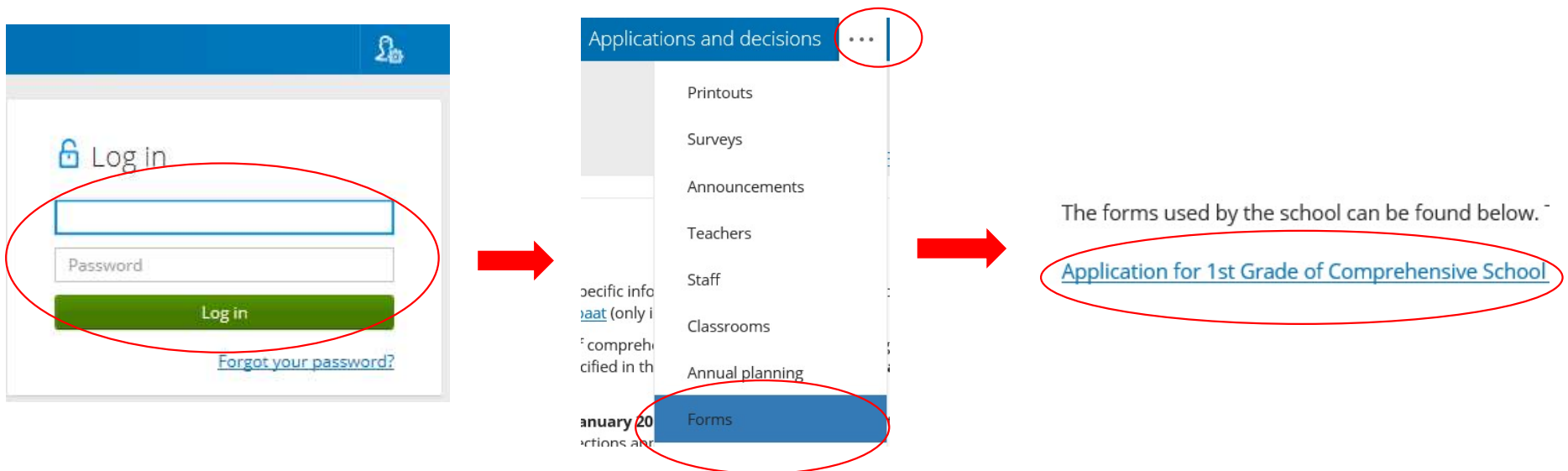

Filling in the form in Wilma

3. NEW PUPIL'S ENROLMENT INFORMATION

Please choose one of the enrolment types (a, b or c)

a) Enrolling for basic education organised by the City of Espoo

☐ The new pupil is enrolling for basic education organised by the City of Espoo.

Please choose one or more of the following options.

☐ The new pupil is applying to a local school. Please fill out section 4 of the form (Applying to a local school).

☐ The new pupil is enrolling for inclusive preparatory education. Please fill out section 4 of the form (Applying to a local school).

☐ The new pupil is applying for bilingual education, language immersion education, English-language education or Montessori education.

5.1 Application preferences

1st preference:

2nd preference:

3rd preference:

4th preference:

5.3 English-language education

The child's sibling is admitted as a pupil in English-language education other than in the highest grade.

Personal identity code of the sibling:

- 1) **Inform** in section 3 of the form that your child is enrolling for basic education organised by the City of Espoo.
- 2) **Specify** in section 3 of the form the enrolment type **and inform** that your child is applying for Bilingual education, Swedish-language immersion education, English-language education or Montessori education.
- 3) **Select** in section 5.1. of the form Espoo International School and Kivimies International School in order of preference.
- 4) **Inform** in section 5.3. of the form if you child has a sibling in English-language education.

Unable to use Wilma?



1) **Fill in a paper form** 'Application for 1st grade of comprehensive school'. The form can be found at espoo.fi/en/education-forms.

2) **Submit the form by 20 January, 2026 at the latest** to the following address:
The Finnish Basic Education Unit
Administrative services / Oppilaaksiotto 1. luokka
P.O. Box 31, FI-02070 City of Espoo.

or

by email to: oppilasrekisteri@espoo.fi.

Applications submitted after the application period are rejected and the applicants will not be given a right to participate in the entrance examination.



CITY OF ESPOO
Growth and Learning Sector
Finnish Basic Education Unit

APPLICATION FOR 1st GRADE OF
COMPREHENSIVE SCHOOL
School year 2026-2027

Enrolling in the 1st grade of comprehensive school takes place through the electronic Wilma service between 8th and 20th January, 2026. Fill in this application form if you are unable to use Wilma. Familiarize yourself with the instructions and admission criteria at espoo.fi/en/schooladmissions before filling in this form.

Submit this form by 20 January, 2026 at the latest to the following address: The Finnish Basic Education Unit, Administrative services / Oppilaaksiotto 1. luokka, P.O. Box 31, FI-02070 CITY OF ESPOO, or by email to oppilasrekisteri@espoo.fi. Ensure that separate attachments or statements are submitted by the deadline (dates specified later in this form and at espoo.fi/en/schooladmissions). Applications, attachments or statements delivered after the deadline will not be considered! In addition to this form, fill in the form information about the new pupil (espoo.fi/en/education-forms) by 20 January, 2026 at the latest. The information provided on the form in question will not affect your child's local school assignment or pupil admission.

| | | | |
|-----------------------------------|--|-------------|------------------------|
| 1 CHILD'S BASIC INFORMATION | Last name | First names | Personal identity code |
| | Home address | | Postcode and city/town |
| | Current pre-primary education unit (name of school/day-care centre)* | | |
| | * Will not affect the school assigned to the child. The information is needed for transferring necessary information from the pre-primary education unit to the child's future school. | | |
| 2 GUARDIANS' INFORMATION | Last name | First names | Telephone (daytime) |
| | Home address (if not shared with the child) | | Postcode and city/town |
| | E-mail address | | |
| | Last name | First names | Telephone (daytime) |
| | Home address (if not shared with the child) | | Postcode and city/town |
| | E-mail address | | |

The entrance examination

- The entrance examination **consists of two sections**:
 - 1) English language section
 - 2) Linguistic competence section
- **27-28 January, 2026** at the school which is marked as the first choice for English-language education:
 - **27 January, 2026**: English language section
 - **28 January, 2026**: Linguistic competence section (in English)
- The school will send a **personal invitation** to the examination by email. Remember to give a valid email address on the application form.
- The examination arrangements and the assessment are the same for all applicants!

Preparing for the entrance examination

- The entrance examination consists of **preschool-type assignments appropriate for the age group**. Your child is not required to be able to read and write, but must be able to listen to and follow instructions.
- **Find** out beforehand where the Espoo International School is located and how to get there. **Ensure** that your child will arrive at the school in good time before the examination starts.
- If you wish, the child can bring along a bottle of beverage and a small snack.
- **If your child is ill** on the date(s) of the entrance examination, **present a statement** on the illness to the principal **before** the examination starts or as soon as you receive it.

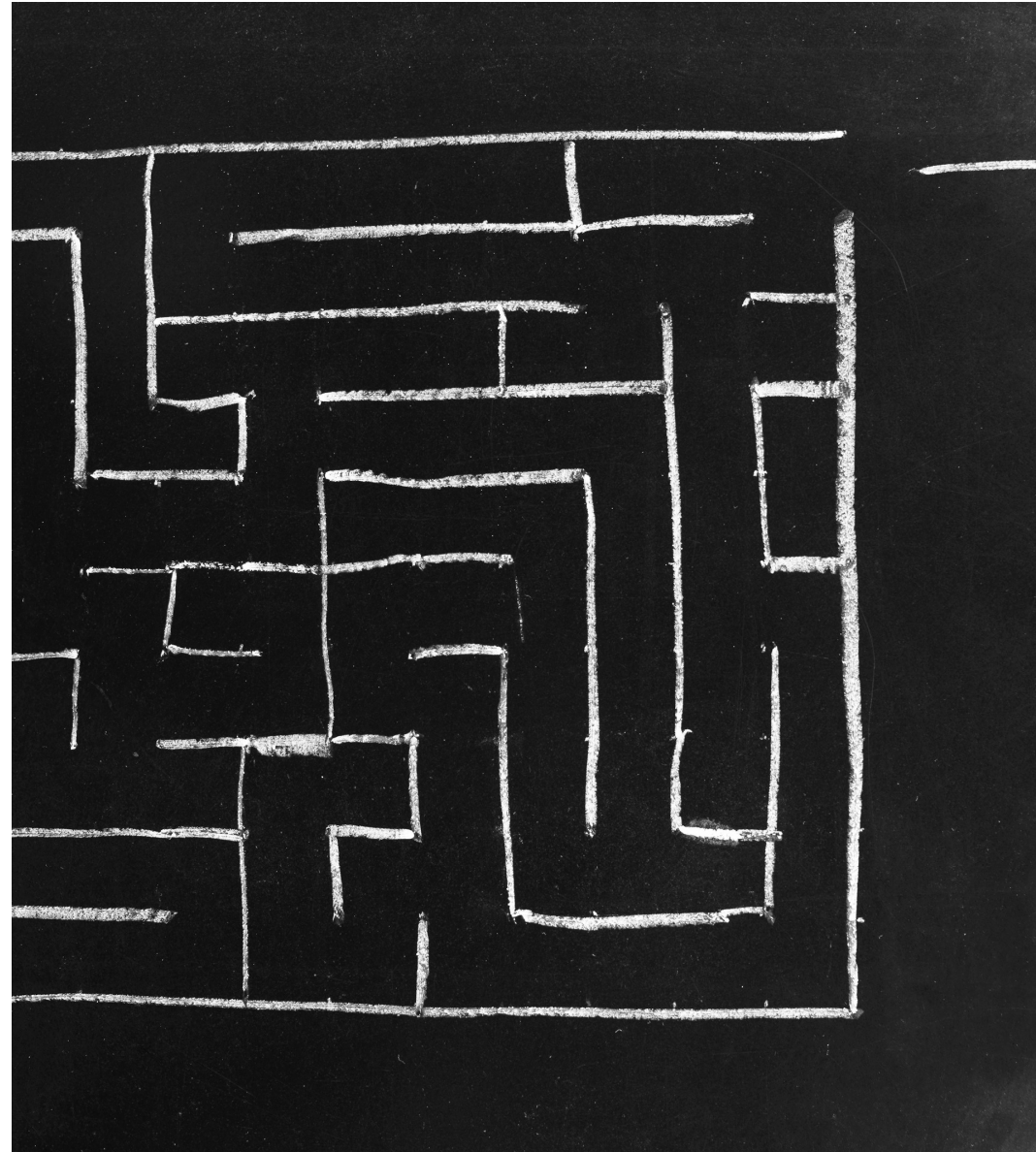

Starting school one year earlier



Requires applying for exceptional start of Basic Education AND a granted permission (i.e. written decision) for early school start made by the Superintendent of Schools.

- 1) **Book** a psychological assessment appointment for your child. Assessments are carried out privately (e.g. Mehiläinen, Pro Neuron, Pikkujätti or Terveystalo). As a parent, you are responsible for any costs the assessments may incur.
- 2) **Contact** the Finnish Education Unit to receive a key code to create Your own personal Wilma account (tel. +358 40 507 0817 or oppilasrekisteri@espoo.fi).
- 3) **Create** your own personal Wilma account at <https://espoo.inschool.fi/connect>
- 4) **Fill in** the form 'Application for 1st Grade of Comprehensive School' between 8th and 20th January, 2026 (through the electronic Wilma service) or submit a paper form **by 20 January, 2026 at the latest**.
- 5) **Fill in** the form 'Application for exceptional start of basic education' at espoo.fi/en/education-forms and **submit** it with the psychological report (and medical report if needed) **by 6 February, 2026 at the latest** to the address informed in the application form.



CITY OF ESPOO
Growth and Learning Sector
Finnish Basic Education Unit

APPLICATION FOR EXCEPTIONAL
START OF BASIC EDUCATION
Basic Education Act 27 §

Compulsory education begins during the year when the child turns seven. The child is entitled to start basic education a year before the statutory age if psychological and, when necessary, medical examinations show that he/she has the prerequisites to cope with the studies. On the basis of the aforementioned examinations, the education provider may also give the child permission to start basic education a year after the statutory age.

Visit espoo.fi/en/schooladmissions for additional information. Submit this application and appendices by 6 February 2026 at the latest. Return address (below):

- 1) Starting basic education one year earlier > The Finnish Basic Education Unit, Administrative Services, Pupil Administration Expert Jemina Sirviö, P.O. Box 31, FI-02070 CITY OF ESPOO.
- 2) Starting basic education one year later > The Finnish Basic Education Unit, Education support, P.O. Box 31, FI-02070 CITY OF ESPOO.

In addition to this form, fill in a form: Application for 1st grade of Comprehensive School through the Wilma electronic service between 8th and 20th January 2026. If You are unable to use the Wilma, You fill in the paper form (espoo.fi/en/education-forms) and submit it by 20 January 2026 at the latest. The return address is on the form.

| | | |
|--|--|------------------------|
| 1 CHILD'S INFORMATION | Child's name (last name, first names) | Personal identity code |
| | Home address | Postcode and city/town |
| 2 GUARDIAN'S INFORMATION | Guardian | Telephone number |
| | Home address (if not shared with the child) | Postcode and city/town |
| | Guardian | Telephone number |
| | Home address (if not shared with the child) | Postcode and city/town |
| 3 INFORMATION ON THE APPLICATION | I am applying for permission for my child to start basic education | |
| | <input type="checkbox"/> a year before the compulsory school-age <input type="checkbox"/> a year after the compulsory school-age | |
| 4 APPENDICES TO THE APPLICATION | <input type="checkbox"/> Psychologist's statement (obligatory) <input type="checkbox"/> Doctor's statement (optional) <input type="checkbox"/> Other (optional); please specify: | |

Moving to Espoo before school year 2026-2027 starts

- **Contact** the Finnish Basic Education Unit to receive a keycode to create Your own personal Wilma account
 - tel. +358 40 507 0817
 - oppilasrekisteri@espoo.fi
- **The application procedure** is the same as applicants living in Espoo.
- Your child can only be admitted under a conditional decision, which will enter into force only if he/she moves to Espoo **on 3 August, 2026 at the latest**. The address given in the form must be registered and available in the Digital and Population Data Services Agency on that day at the latest.



Admission criteria for English-language education

Admitting applicants to 1st Grade

Admission is based on an entrance examination. The entrance examination consists of two sections:

- 1) English test (0–30 points)
- 2) Linguistic skills test (0–45 points).

The entrance examination is taken in English. Applicants must get at least 20 points from the English test and at least 30 points from the linguistic skills test so that at least 7 points are attained from each task in the test.

Applicants who have passed the entrance examination will be ranked in the order of the total score they have received from the entrance examination. From among the applicants, as many of the highest-scoring applicants are considered as there are available study places. Applicants are admitted in the following order of priority:

1) Applicants meeting the sibling criteria and the highest total score

A sibling refers to an older sibling who lives at the same address and who is admitted as a pupil in English-language education other than the highest grade. On the application form, the guardian must mention that they are applying with the sibling criterion.

Applicants are admitted in the order of the total score they have received from the entrance examination. If the total score of the applicants is the same, the order of the applicants is determined by drawing lots.

2) Other applicants with the highest total score

Applicants are admitted in the order of the total score they have received from the entrance examination. If the total score of the applicants is the same, the order of the applicants is determined by drawing lots.

If there are still available study places after the admitting applicants referred to in sections 1–2 above, applicants who have passed the entrance examination will be admitted in the order of the total score they got in the entrance examination. When the applicants' total score is the same, the order is determined by the sibling criterion (an applicant's sibling is admitted as a pupil in English-language education other than the highest grade). If these applicants also meet the sibling criterion, their order is determined by drawing lots.

Decisions and delivery

Decisions and delivery

- **You can choose the means of delivery for the decision** when filling in the form 'Application for 1st grade of comprehensive school'.
- There are **two options**:
 - 1) The decision will be **published in Wilma on 24 April, 2026**. The decision will not be delivered by post.
 - 2) The decision will be **mailed on 24 April, 2026**. The decision will not be published in Wilma.
- **It is possible to choose only one.**
The choice is binding!

After decisions are made

If your child is admitted to English-language education

- **The place will not have to be accepted separately.** The decision will continue in force for the duration of the grades taught in the school.
- Your child is **not entitled** to the school transport subsidy and his/her younger siblings have **no right** to admission to the same school under the sibling principle.
- **Notify the principal** of the school **if your child** moves away or gives up the school place and requests assignment to a local school.



If your child is not admitted English-language education

- Your child **cannot reapply** for English-language education in 1st Grade **and/or complete the entrance examination again.**
- Your child will be **assigned to a local school on 24 April, 2026.** If your child has little or no knowledge of the Finnish language he/she will be **assigned to preparatory education.**
- Your child can **apply for a place in a secondary school** by submitting a separate form **by 26 May, 2026.** Instructions and admission criteria can be found at espoo.fi/en/schooladmissions > [Local school and secondary school | City of Espoo](#)
- You can **appeal the decision** by submitting a written demand for rectification. The decision is accompanied by detailed instructions.

Application for afternoon activity of basic education

- Fill in the form 'Application for afternoon activities' in Wilma (<https://espoo.inschool.fi/>) **between 24 April and 10 May, 2026.**
- If you are unable to fill in the form in Wilma, you can fill in a paper form at espoo.fi/en/education-forms. The paper form must be submitted to arrive **by 10 May, 2026 at 3:45 pm at the latest** to the following address:
Finnish Basic Education Unit
Support Services, Afternoon activities
P.O. Box 31, FIN-02070 City of Espoo
OR
by email to: iltapaivatoiminta@espoo.fi.

Additional information: espoo.fi/iltapaivatoiminta



Tips for the guardians

- **Familiarize yourself** with the instructions and the admission criteria at espoo.fi/en/schooladmissions > Weighted-curriculum education > English-language education.
- **Ask** if anything related to the application or admission criteria is unclear and/or you need further information.
- **Fill in the form in good time**, as Wilma will be busy towards the end of the application period. The form is not available after application period ends.
- If you fill in the paper form, **ensure** that it will arrive by the given deadline. Applications arriving after the given deadline will be disregarded.
- **Give a valid email address** on the form as the school will send a personal invitation to the examination using that email.
- **Find out** beforehand where the school arranging the entrance examination is located and how to get there.