

Applying for English-language education for the 7th Grade

School year 2026-2027

Espoo International School

About arranging basic education

- Espoo, like other municipalities, has an obligation to arrange basic education for children of compulsory school age residing in its area. **Pupils have a subjective right to attend a local school** (primary school) assigned by the municipality. Basic education is given in Finnish.
- Pupils who cannot yet speak Finnish or whose Finnish language skills are not equivalent to those of a native speaker **have the opportunity to be supported in increasing their Finnish language skills and to participate in preparatory education.**
- **Pupils can also apply** for a place in English-language education. Pupils, however, **do not have a subjective right to be admitted** to English-language education, as opposed to applying to a local school.





English-language education in Espoo

- Intended for pupils in basic education **who live in Espoo.**
- One form of **weighted-curriculum education** in Espoo.
- **Nearly all the teaching is in English.** The aim is to give the pupils the kind of linguistic skills that enable them to continue their studies in both English and Finnish even after basic education.
- **Follows the national Finnish curriculum in all subjects.** The A1 language is English and the A2 language either French or Spanish. Finnish is studied either as mother's tongue or according to the Finnish as a Second Language curriculum (S2).
- Pupils are admitted for English-language education in accordance with **the admission criteria** decided by the Growth and Learning Committee.

The differences between English-language education and Bilingual (Finnish-English) education

| English-language Education | Bilingual Education (Finnish-English) |
|--|--|
| Finnish National Core Curriculum for Basic Education | |
| Allocation of lesson hours, slight differences FIN vs. ENG | |
| English as medium of instruction for all subjects | More subjects taught in Finnish in higher grades |
| International School | Stream within a Finnish School |



Study places for the school year 2026-2027

- A maximum of **100 applicants** meeting the admission criteria.
- Including pupils attending English-language education in the 6th Grade at Espoo International School and Kivimies International School, who continue studying in English-language education in the 7th Grade.

How to apply

Enrolling in the 7th Grade and applying for English-language education

- **Pupils attending English-language education in the 6th Grade at Espoo International School** are not required to apply for English-language education in 7th grade if they are continuing studying in English-language education.
- **Pupils attending English-language education in the 6th Grade at Kivimies International School** are required to apply for English-language education through the electronic Wilma service <https://espoo.inschool.fi/> between 8th and 15th January, 2026 by filling in the form 'Application for 7th grade of comprehensive school'. However, pupils are not required to take part in an entrance examination on 21 January, 2026.
- **New applicants** are required to apply for English-language education through the electronic Wilma service <https://espoo.inschool.fi/> between 8th and 15th January, 2026 by filling in the form 'Application for 7th grade of comprehensive school'. Applicants are also required to take part in an entrance examination on 21 January, 2026.



Before applying for English-language education

Familiarize yourself with the instructions and the admission criteria. Visit at espoo.fi/en/schooladmissions
> Weighted-curriculum education > English-language education.



[Front page](#) / [Childcare and education](#) / [Basic education](#) / [School admissions](#)

School admissions

On this page, you can find instructions for applying to a comprehensive school and information on weighted-curriculum education.

- Local school and secondary school
- Special education
- Weighted-curriculum education**
- When a pupil moves
- Preparatory education
- Early or postponed school start

Useful links

- Forms and applications for basic education
- Afternoon activities
- English-language education
- Wilma
- School transportation and transportation benefits
- For people arriving from Ukraine and seeking for basic education

[Front page](#) / [Childcare and education](#) / [Basic education](#) / [School admissions](#) / [Weighted-curriculum education](#) / [English-language education](#)

English-language education

English-language is one form of weighted-curriculum education in Espoo. English-language is arranged in Espoo International School and Kivimies International School, and meant for pupils living in Espoo and Kauniainen. A pupil can apply for either a permanent study place or a temporary study place.

Pupils are admitted for English-language education in accordance with the admission criteria decided by the Growth and Learning Committee. Pupils admitted to English-language education are not eligible for school transport benefit (such as school transport or travel card).

Pupils do not have a subjective right to be admitted to English-language education, as opposed to a local school. Before you fill in the application form, familiarize yourself with the instructions and the admission criteria down below.

| | |
|--|---|
| Applying for 1st grade (school year 2026-2027) | ▼ |
| Applying for grade 4 (school year 2026-2027) | ▼ |
| Applying for 7th grade (school year 2026-2027) | ▼ |
| Applying for a temporary study place | ▼ |
| Admission criteria | ▼ |

Filling in the form in Wilma

Log in to your personal Wilma account at <https://espoo.inschool.fi/>.

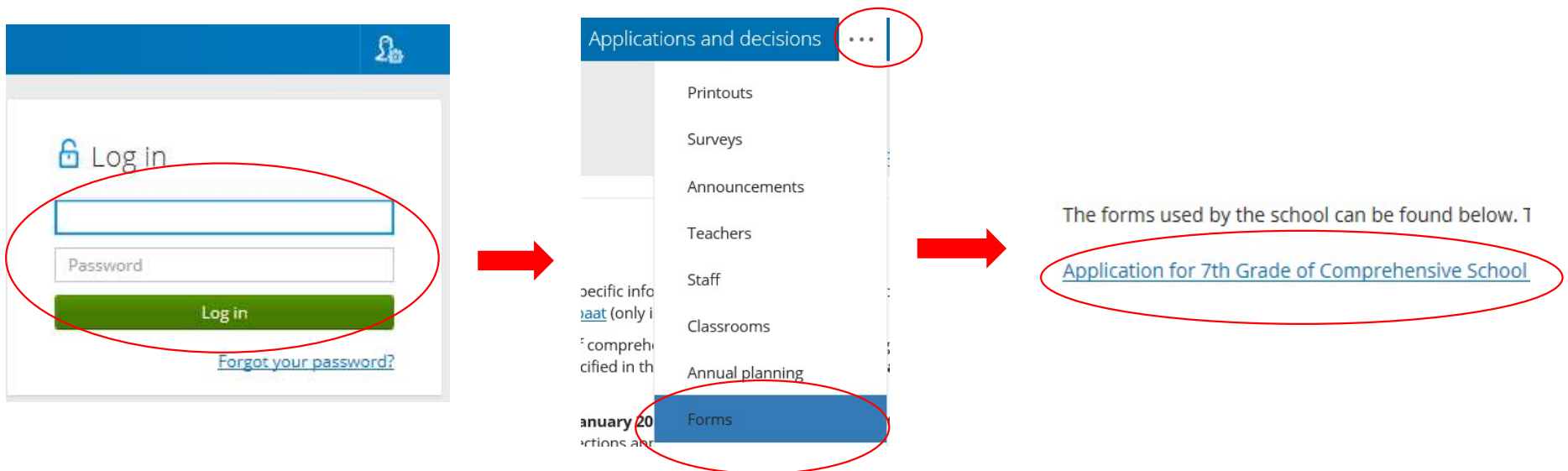

Filling in the form in Wilma

4. APPLYING FOR WEIGHTED-CURRICULUM EDUCATION

☐ The pupil is applying for Weighted-curriculum education, English-language education, Bilingual education (Finnish-English) or Swedish-language immersion education.

Indicate the application order below with the number 1–4 (1 = first preference, 2 = second preference, etc.). It is possible to apply for up to four schools/forms of education. The indicated application order is binding! Check the entrance examination dates and additional instructions at [espoo.fi/en/schooladmissions](https://www.espoo.fi/en/schooladmissions) (<https://www.espoo.fi/en/childcare-and-education/school-admissions>) > Weighted-curriculum education.

4.1 Application preferences

You can open the whole list by clicking the button at the end of the field.

1st preference:

2nd preference:

3rd preference:

4th preference:

4.5 English-language education

☐ The pupil's sibling is admitted as a pupil in English-language education other than in the highest grade.

Personal identity code of the sibling:

- 1) **Inform** in the section 4 of the form that your child is applying for weighted-curriculum education...
- 2) **Indicate** in the section 4.1. of the form English-language education at Espoo International School as an application preference.
- 3) **Indicate** in the section 4.5. of the form if your child has a sibling admitted as a pupil in English-language education.

Unable to use Wilma?



- 1) **Fill in the paper form** 'Application for 7th grade of comprehensive school'. The form can be found at espoo.fi/en/education-forms.
- 2) **Submit the paper form** to your child's current school in Espoo **by 15 January, 2026 at the latest**. If your child resides and/or studies in another municipality, submit the form to the following address:
The Finnish Basic Education Unit
Administrative services / Oppilaaksiotto 7. luokka
P.O. Box 31, FI-02070 City of Espoo
or
by email to: oppilasrekisteri@espoo.fi

Applications submitted after the application period are rejected and the applicants will not be given a right to participate in the entrance examination.



CITY OF ESPOO
Growth and Learning Sector
Finnish Basic Education Unit

APPLICATION FOR 7th GRADE
OF COMPREHENSIVE SCHOOL
School year 2026-2027

Enrolling in the 7th grade of comprehensive school takes place **between 8th and 15th January 2026**. If your child is studying in a joint comprehensive school in the 6th grade and he/she continues to study in that school in the 7th grade, do not fill in this form.

Familiarize yourself with the instructions and principles of pupil admission at espoo.fi/en/schooladmissions before filling in this form.

Submit this form to your child's current school in Espoo by **15 January 2026 at the latest**. If your child is attending a school in another municipality, submit this form to the following address: The Finnish Basic Education Unit, Administrative services / Oppilaaksiotto 7. luokka, P.O. Box 31, FI-02070 CITY OF ESPOO or by email to: oppilasrekisteri@espoo.fi. Ensure that separate applications or statements are submitted by deadlines specified in this application form and at espoo.fi/en/schooladmissions. Application forms and statements submitted after deadlines will not be considered!

| | | | |
|---|--|-------------|---------------------------|
| 1 PUPIL'S BASIC INFORMATION | Last name | First names | Personal identity code |
| | Home address | | Postal code and city/town |
| | Current school | | |
| 2 GUARDIANS' INFORMATION | Last name | First names | Telephone (in daytime) |
| | Home address (if not shared with the child) | | Postal code and city/town |
| | E-mail address | | |
| | Last name | First names | Telephone (in daytime) |
| | Home address (if not shared with the child) | | Postal code and city/town |
| 3 COUNTRY | | | |
| 4 APPLYING FOR WEIGHTED- CURRICULUM EDUCATION | <p>A pupil can apply for weighted-curriculum education, English-language education, Bilingual education (Finnish-English) and Swedish-language immersion education. If a pupil applies for these forms of education, a local school is assigned only if the pupil is not admitted to the education he/she applies. It is advised to fill in section 3 of this form for this purpose.</p> <p>Pupils admitted to weighted-curriculum education, English-language education, Bilingual education (Finnish-English) and Swedish-language immersion education are not entitled to school transport subsidy, and the younger sisters or brothers of the pupil are not entitled to be admitted to the same school when enrolling to a local school. If a pupil is admitted to a school where he/she is unable to study the A2-language started in the primary school, the A2-language in question ends.</p> <p>4.1. Application preferences</p> <p>Indicate the application preferences in order with the number 1-4 (1 = first preference, 2 = second preference, etc.). It is possible to apply for up to four schools or forms of education. The indicated order is binding! Check the entrance examination dates and additional instructions at espoo.fi/en/schooladmissions > Weighted curriculum education.</p> <p>English-language education <input type="checkbox"/> Espoo International School</p> | | |

The entrance examination

- The entrance examination will be arranged
 - on **21 January, 2026 at 9 am**
 - at **Espoo International School** (address: Lillhemntintie 1).
- **No separate invitation! All applicants must arrive at the school by 8:45 am.**
- **If your child is ill on the examination date and is unable to take the entrance examination**, another entrance examination can be organised for him/her.
 - You are required to **present a statement** on the illness to the principal **before** the examination starts (or as soon as you receive it).
- Pupils attending English-language education in the 6th grade at Espoo International School and Kivimies International School are **not required to take part in the entrance examination.**





Moving to Espoo before school year 2026-2027 starts

- 1) **Fill in** the paper form 'Application for 7th grade of comprehensive school' (espoo.fi/en/education-forms)
- 2) **Submit** the paper form **by 15 January, 2026 at the latest** to the following address:
The Finnish Basic Education Unit
Administrative services / Oppilaaksiotto 7. luokka
P.O. Box 31, FI-02070 City of Espoo
or by email to: oppilasrekisteri@espoo.fi

Your child must take part in the entrance examination **on 21 January, 2026** at the same time as Espoo residents.

Your child can only be admitted under a conditional decision, which will enter into force only if he/she moves to Espoo **on 3 August, 2026 at the latest**. The address given in the form must be registered and available in [the Digital and Population Data Services Agency](#) on that day at the latest.

Admission criteria

Admission to the 7th grade

Pupils studying in the 6th grade in English-language education at a comprehensive school (grades 1-9) in Espoo continue studying in the same school without a separate application.

After admitting pupils studying in English-language education at a comprehensive school in Espoo and pupils studying in the 6th grade in a primary school (grades 1–6), **new applicants can be admitted for vacant study places based on the entrance examination (0–100 points). The applicant must get at least 67 points as the total score.** Applicants are admitted in the order of the total score they have received from the entrance examination. When the applicants' total score is the same, the order is determined by the sibling criterion (an applicant's sibling is admitted as a pupil in English-language education other than the highest grade). If these applicants also meet the sibling criterion, their order is determined by drawing lots.

Visit at espoo.fi/en/schooladmissions > Weighted-curriculum education > English-language education > Admission criteria

Decisions and delivery

Decisions and delivery

- **You can choose the means of delivery for the decision** when filling in the form Application for 7th grade of comprehensive school.
- There are **two options**:
 - 1) The decision will be **published in Wilma on 8 April, 2026**. The decision will not be delivered by post.
 - 2) The decision will be **mailed on 8 April, 2026**. The decision will not be published in Wilma.
- **It is possible to choose only one.** The choice is binding!



After decisions are made

If your child is admitted to English-language education

- **The place will not have to be accepted separately.** The decision will continue in force for the duration of the grades taught in the school.
- Your child is **not entitled** to the school transport subsidy and his/her younger siblings have **no right** to admission to the same school under the sibling principle.
- **Notify** the principal of the Espoo International School **if your child** moves away or gives up the school place and requests assignment to a local school.



If your child is not admitted to English-language education

- Your child will be **assigned to a local school on 8 April, 2026**. If your child has little or no knowledge of the Finnish language he/she will be **assigned to preparatory education**.
- Your child can **apply for a place in a secondary school** by submitting a form Toissijaiseen kouluun hakeminen (only in Finnish) **by 29 April, 2026 at the latest**.
- You can **appeal the principal's decision** by submitting a written demand for rectification. The decision is accompanied by detailed instructions.

Tips for the guardians

- **Fill in the application form in good time**, as Wilma will be busy towards the end of the application period. The form is not available after application period ends.
- If you fill in the paper form, **ensure** that it will arrive by the given deadline. Applications arriving after the given deadline will be disregarded and will not give the right to participate in the entrance examination.
- **Familiarize yourself** with the instructions and admission criteria at espoo.fi/en/schooladmissions
 - > Weighted-curriculum education
 - > English-language Education.
- **Find out** beforehand where the Espoo International School is located and how to get there.
- **A local school is assigned to your child only if** he/she is not admitted to English-language education (or other weighted-curriculum education) he/she applies.
- **Ask** if anything related to the application or admission criteria is unclear and/or you need further information.